

E	ML 12,70	ML 17,20	ML 6,50	ML 10,03	MQ 42,15
F	ML 12,50	ML 12,70	ML 4,00	ML 18,20	MQ 34,22
G	ML 14,30	ML 10,50	ML 10,10	ML 14,60	MQ 24,85
H	ML 30,10	ML 38,50	ML 14,30	ML 33,15	MQ 122,03
I	ML 9,20	ML 27,00	ML 30,10	ML 41,45	MQ 194,11
				ML 17,45	MQ 52,99
				TOTALE	MQ 1428,40

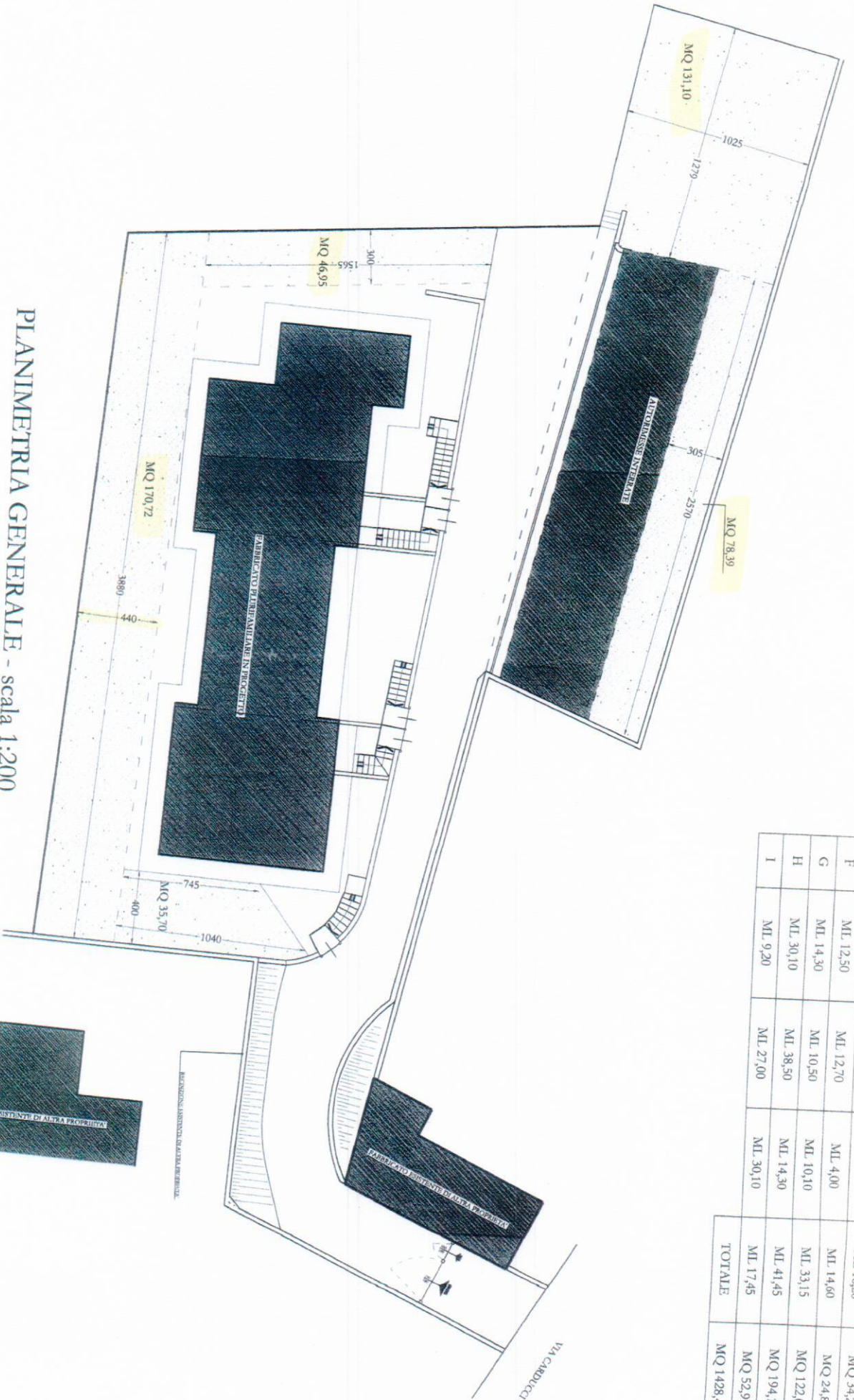

PLANIMETRIA GENERALE - scala 1:200

CALCOLO SUPERFICIE DRENANTE:  
 Superficie terreno => mq 1428,40  
 Superficie drenante libera = mq (35,70+170,72+46,95+78,39+131,10) = mq 462,86 > mq 428,52 (= 30% di mq 1428,40) - VERIFICATO